



THE GRANDS BOULEVARDS JOINERIES



BATIMAT 2007
INNOVATION AWARDS
GOLD MEDAL



The spirit of tradition

Founded in 1760, Perrault has 2.5 centuries of experience creating and restoring traditional woodworks. Today, we are one of France's leading practitioners in the field of restoration and reproduction joinery.



Working in collaboration with the "Architectes des Bâtiments de France" our workshops have conceived a range of joineries combining 19th century tradition with 20th century comfort: "The Grands Boulevards".

Designed and manufactured with the quality and attention to detail of a traditional joinery, with assembled and mitred joints, a "mouton gueule de loup" closing system and classic mouldings, our range "Grands Boulevards" meets with modern standards for both phonique and thermal insulation with options for flame and burglar proofing.



In response to an increasing demand for comfort and convenience, we are pleased to present also our new line in aluminium clad windows. The warmth of wooden interior is maintained using the same mouldings and muntins as wooden joineries reproduced on the exterior by our aluminium cladding, assuring a classic appearance and a hardwearing finish.

As nothing is too good to furnish your home, our joiners make it a point of honour to produce work that adds to your quality of life.

Created to order, our joineries become integrated into your home either in restoration or in new projects.

To improve this integration, **we can restore or renovate existing shutters, existing cremones or espagnolettes.** We match wood aspect and finishes to ensure a perfect integration in the existing environment.

We accompany each project from its conception, with meticulous attention to detail, through to the finishing touches and guaranteed customer satisfaction.

Ateliers Perrault signing of the French Quality Charter "Menuiseries 21" underlines not only our dedication to quality but also our commitment to preserving the environment.



We respect the following commitments:

- Technical Quality:

The technical exigencies made by the charter require us to:

- subject our joineries to test carried out by France's official regulator the "Centre Technique du Bois et de l'Ameublement (CTBA),
- indicate clearly the results of these tests,
- respect a rigorous programme of auto-control defined by the Charters ruling committee,
- keep an up to date record charting the evolution of our fabrication process.

- Environmental Quality:

As the respect of environment is one of our most important concerns, we have set up a process, with the Agency for the protection of Environment and control of Energy (ADEME), in order to:

- use woods coming from forests managed with environment protection purpose,
- reduce the VOC (Volatile Organic Components) emissions,
- reduce, select and recover our wastes.

- Quality of the service:

We provide you with our experience and skills to help you in the conception of your joineries according to architectural requirements and specific needs (flame protection, intrusion, retardance, bullet proof ...).



19th century windows adapted to the 21st century requirements of comfort.

The «Grands Boulevards» range of doors and windows are perfectly suited to the comfort of modern life, meeting all the rules and standards that govern weatherproofing, thermal insulation, sound insulation, fireproofing and burglar resistance.

Our windows are efficient against the air, wind and water.

Those performances are indicated according to the following references:

A : the air insulation in 4 classes from 1 to 4,

E : the waterproofness in 9 classes,

V : the thermal insulation (against wind) in 5 classes.

Our performance is A*4 E*7B V*C2.

Thermal insulation

Our wood/aluminium range conforms to the 2005 European thermal regulations, obtaining a minimum performance of $2.0\text{W/m}^2\cdot\text{K}$ and offering the possibility of an impressive $1.0\text{W/m}^2\cdot\text{K}$ when combined with certain types of double glazing.

Acoustic reduction is an indicator of soundproofing. The indicator in dB Rw (C; Ctr) denoting the reduction in decibels of both ambient and traffic noise.

Flame protection : wood, with steel, is a material with which you can get a flame protection.



Technical descriptions of our wooden joineries

Traditional 19th-century designs...

- Traditional construction methods,
- Opening doors and windows hinged into rebates (**without over lap**),
- Ogee moulded window drips,
- Central closing with interlocking half-round mouldings,
- Interior shutters made or re-used,
- Raised and fielded lower panels,
- Horizontal impost with flattened bird's-beak moulding (optional).

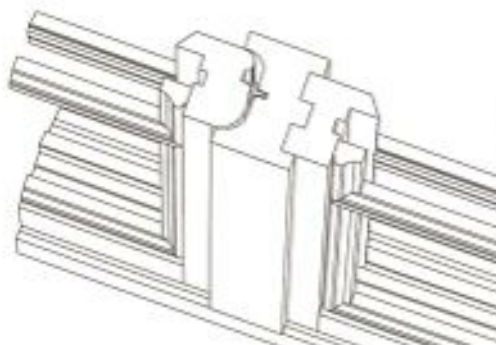

... in meticulously selected timber ...

- French oak or exotic woods free of sapwood and not chemically treated,
- Solid or laminated timber
- Derived from sustainable forests.



... with designs suited to modern life ...

- Sealed-unit double glazing to meet the needs of sound and heat insulation,
- Mounted on inner ledges, with 19th-century mouldings and mitre joints,
- Assembled and glued (muntins)
- On the outside in imitation of putty with 37° slope,
- Thermoplastic elastomer insulating joint protected with a peelable film.

... offering a finish to satisfy the most demanding taste.

- Fastened by surface-mounted espagnolettes or forged casement bolts, chosen to match your interior decor,
- Existing espagnolettes and casement bolts may be re-used,
- Mounted on reinforced hinges, with optional period hinges, cabinet hinges, etc...
- Choice of varnished or painted finish.



58 mm doors and windows: with a high standard of sound and heat insulation for your comfort

Classification of water and wind tightness:

A*4 E*7B V*C2 (European classification).

Heat insulation performance:

Type of joinery	Wood	Size	Glazing	Uw Coefficient	Uw Coefficient with wooden shutters
French window	medium density hard wood	Height : 2180 mm Width : 1450 mm	4 FE* - 16 GA** - 4	1,5 W/m ² K	1,3 W/m ² K

* FE : Low emission

**GA : Argon

Acoustic performance:

- With 4 FE* - 16 GA** - 4 double glazing our doors and windows offer an acoustic reduction of **33 dB (-2; -3) Rw (C; Ctr)** (laboratory).

- With 4 FE* - 14 GA** - 6 double glazing our doors and windows offer an acoustic reduction of **35 dB (-2; -3) Rw (C; Ctr)** (laboratory).

- With 44.6 Classe 5 double glazing our doors and windows offer an acoustic reduction of **35 dB Rw (C; Ctr)** (laboratory). They also offer an intrusion retardance.

*RA : Reinforced sound reduction



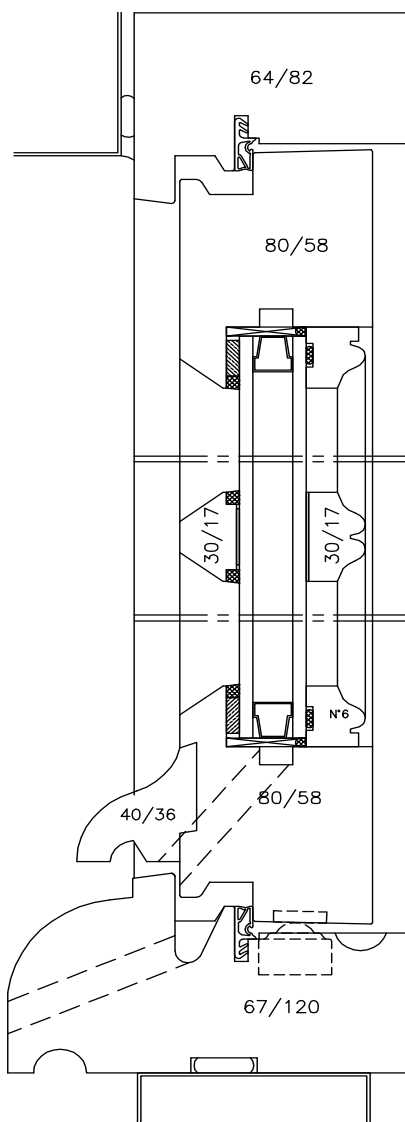

**VERTICAL SECTION
OF A WINDOW**

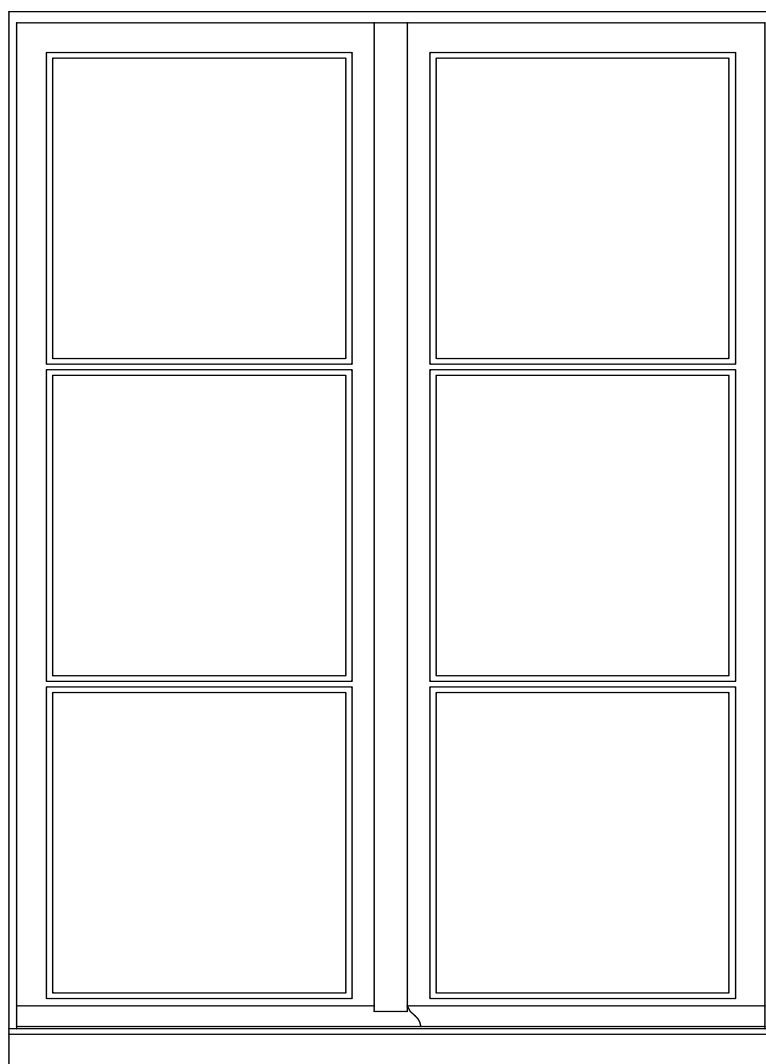

**EXTERIOR SIDE
OF A WINDOW**

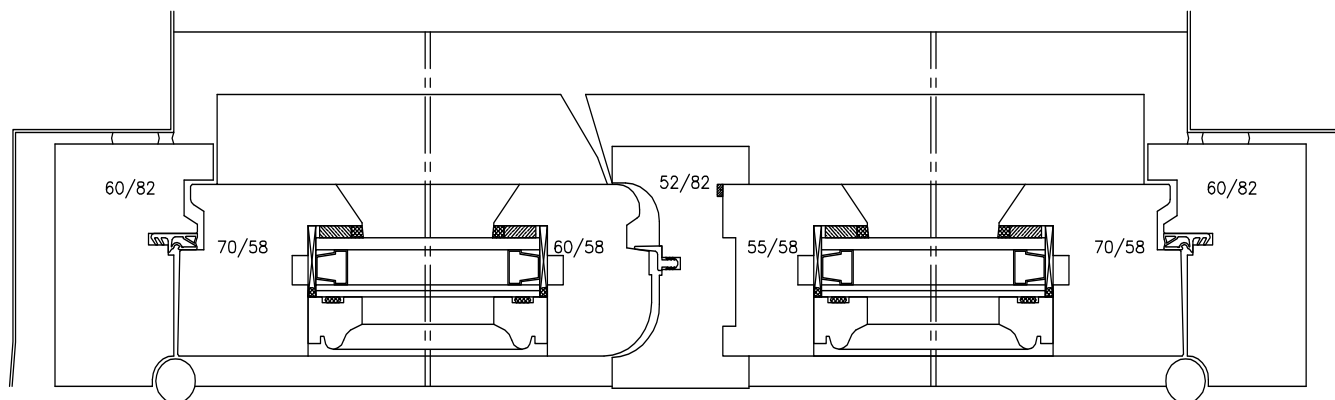

HORIZONTAL SECTION OF A WINDOW

68 mm doors and windows: specifications to meet your highest requirements...

Classification of water and wind-tightness:

A*4 E*7B V*C2 (European classification).

Heat insulation performance:

Type of joinery	Wood	Size	Glazing	Uw Coefficient
French window	Medium density hard wood	Height : 2180 mm Width : 1450 mm	4 FE* -16 Argon - 4 Double glazing (24 mm)	1,4 W/m²K
French window	Medium density hard wood	Height : 2180 mm Width : 1450 mm	4 FE* - 10 Argon - 4 - 10 Argon - 4 Triple glazing (32 mm)	1,2 W/m²K

* FE : Low emission

Acoustic performances :

- With 44.2 RA* - 12 - 10 double glazing, our doors and windows offer an acoustic reduction of **38 dB Rw (C; Ctr)** (laboratory).
- With 64.2 RA* - 12 - 44.2 RA* double glazing, our doors and windows offer an acoustic reduction of **42 dB Rw (C; Ctr)** (laboratory).

* RA :

Burglar resistance:

With **class 3** burglary resistance according to standard XP ENV 1627, certified by the CNPP (National Protection and Crime Prevention Centre), our «Grands Boulevards» doors and windows are at present the only ones in France to hold this classification in the «Wooden doors and windows» category.

Options: interior shutters, connection to alarm systems, opening detectors, home automation, automatic openers, etc...



Half-hour flame resistant (test record n° 99 V 088):

Tested by the Metal Construction Industrial Technical Centre. These types of doors and windows are particularly recommended for openings onto shared internal courtyards.

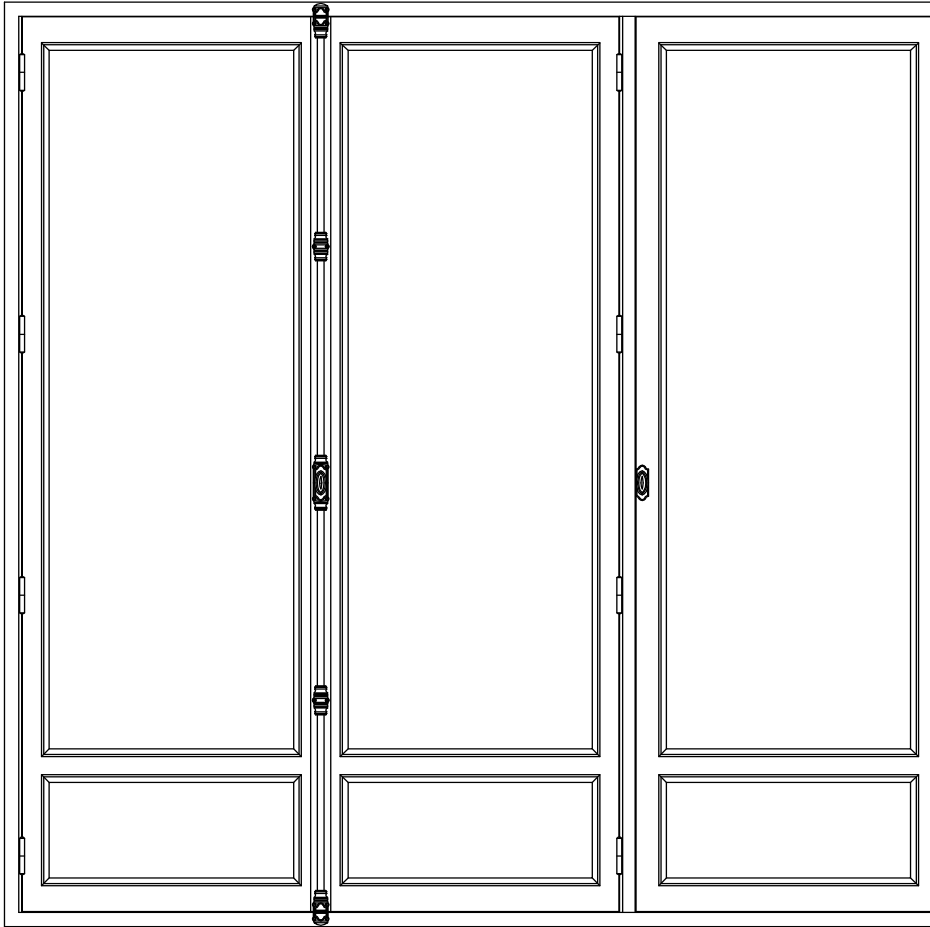

INTERIOR SIDE OF A FRENCH WINDOW

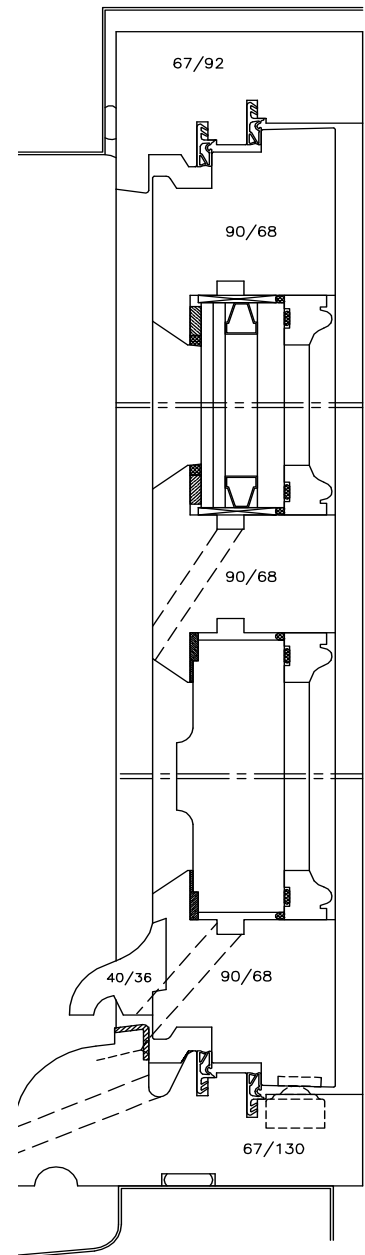

VERTICAL SECTION OF
A FRENCH WINDOW

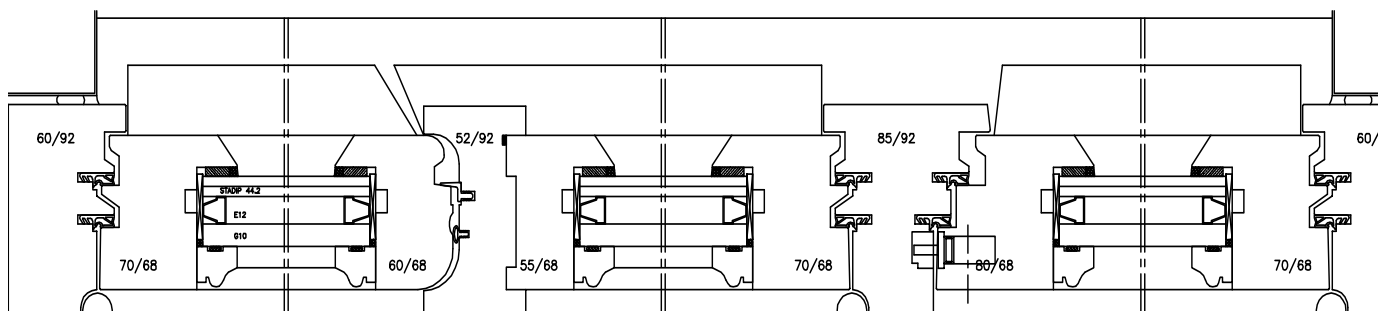

HORIZONTAL SECTION OF A FRENCH WINDOW

Technical description of our wood/aluminium joineries



Particularly adapted to humid and salt atmosphere, aluminium is a good complement for our traditional joineries.

Our wood/aluminium joineries have the same basis than our wooden joineries. It includes :

- the 19th traditional aspect,
- the selection of wood,
- custom-made finishes.

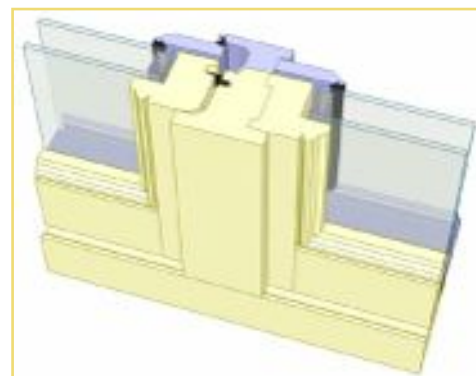

These are the characteristics of the exterior aluminium frame:

- aluminium exterior frame with imitation putty mould,
- **welded angles for a perfect and durable finish**
- solid aluminium moulded drip rail for uniformity and durability
- **thermolaque hardwearing RAL finish applied after assembly** for uniformity and durability, according to the European label QUALICOAT: the quality guarantee for aluminium powder coating.
- a wide range of colours and styles of finish are available upon demand

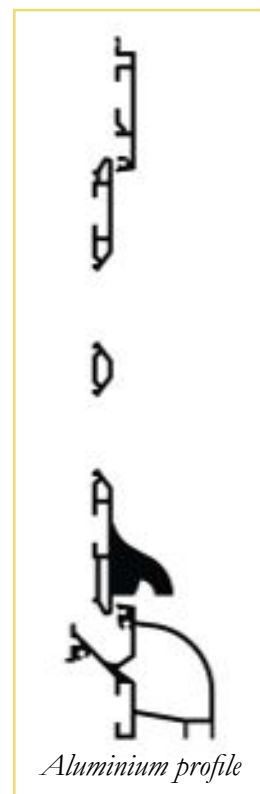

62 mm wood/aluminium doors and windows

Classification of water and wind tightness:

A*4 E*7B V*C2 (European classification).

Heat insulation performance:

Type of joinery	Size	Double glazing	Uw Coefficient	Uw Coefficient with wooden shutters
Window : French wolfs-mouth closing system	Height : 1480 mm Width : 1850 mm	4 FE* - 16 Argon - 8	1,47 W/m²K	1,27 W/m²K
French Window : French wolfsmouth closing system	Height : 2180 mm Width : 1850 mm	4 FE* - 16 Argon - 8	1,39 W/m²K	1,21 W/m²K
Tilt-and-turn window	Height : 1480 mm Width : 1850 mm	4 FE* - 16 Argon - 8	1,46 W/m²K	1,26 W/m²K
Tilt-and-turn French window	Height : 2180 mm Width : 1850 mm	4 FE* - 16 Argon - 8	1,38 W/m²K	1,20 W/m²K

* FE : Low emission

Acoustic performance:

- With 4 - 16 - 8 double glazing our doors and windows offer an acoustic reduction of **38 dB Rw (C; Ctr)** (laboratory).
- With 44.2 RA* - 12 - 8 double glazing our doors and windows offer an acoustic reduction of **41 dB Rw (C; Ctr)** (laboratory).

*RA : Reinforced sound reduction



72 mm wood/aluminium doors and windows

Classification of water and wind tightness:

A*4 E*7B V*C2 (European classification).

Heat insulation performance:

Type of joinery	Size	Glazing	Uw Coefficient	Uw Coefficient with wooden shutters
Window : French wolfsmouth closing system	Height : 1480 mm Width : 1850 mm	4 FE* - 12 Argon - 4 - 14 Argon - 4 FE*	1,14 W/m ² K	1,02 W/m ² K
French Window : French wolfsmouth closing system	Height : 2180 mm Width : 1850 mm	4 FE* - 12 Argon - 4 - 14 Argon - 4 FE*	1,05 W/m ² K	0,94 W/m ² K
Tilt-and-turn window	Height : 1480 mm Width : 1850 mm	4 FE* - 12 Argon - 4 - 14 Argon - 4 FE*	1,18 W/m ² K	1,05 W/m ² K
Tilt-and-turn French window	Height : 2180 mm Width : 1850 mm	4 FE* - 12 Argon - 4 - 14 Argon - 4 FE*	1,08 W/m ² K	0,96 W/m ² K

* FE : Low emission

Acoustic performance :

- With 44.2 RA* - 20 - 55.2 RA* double glazing our doors and windows offer an acoustic reduction of **44 dB Rw (C; Ctr)** (laboratory).

*RA : Reinforced sound reduction.

Burglar resistance:

With **class 3** burglary resistance according to standard XP ENV 1627, certified by the CNPP (National Protection and Crime Prevention Centre), our «Grands Boulevards» doors and windows are at present the only ones in France to hold this classification in the «Wooden doors and windows» category.

Options: interior shutters, connection to alarm systems, opening detectors, home automation, automatic openers, etc...



Wooden or wood/aluminium bullet proof joinery...

... for a high security

Created to order, our joineries offer a protection against firearms according to the risk of attack you might be faced with.

Your joineries are adapted specifically to different criteria :

- Style of the building where they have to be installed,
- Type of business managed in this building,
- Attendance at these buildings,
- Emergency Services,
- Type of firearms to be used.

We also measure the resistance against firearms according to:

- Kind of arms,
- Initial speed of the bullet,
- Shot distance,
- Shape and composition of the bullet.

We can create wooden joineries in any traditional style adapting our frameworks, including various armoured materials to different glazing (classes from 2 to 5).

Full size prototypes have been tested in military firing ranges as shown below :

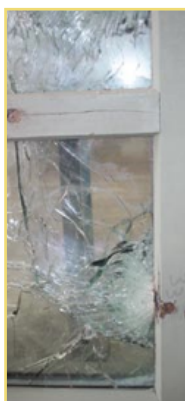

The Grands Boulevards, a large range of equipments



Created to order, our joineries become integrated into your home either in restoration or in new projects.

We provide you with our experience and skills to propose joineries adapted according to your needs and to the requirements of your architectural environment.

This corresponds to the range of our different joineries:

- window,
- French window,
- arched window (only for wooden windows),
- curved window
- joinery with opening or fixed transom (with radiant cross-bars).



According to the opening:

- one leaf,
- two leaves,
- tilt-and-turn window (rebate closing.)



We can also re-use existing elements (made of wood or iron) or we can create identical elements (our locksmith's workshop is at your service):









- jambs,
- interior shutters,
- cremone or espagnolettes,...

We can also integrate other elements on your demand :

- ledges,
- shutters back stop for insulating double partition,
- shutters back stop for window blind,
- aluminium or brass threshold for doors and French windows,
- specific glazing,
- safety materials,
- etc...

Quality... our priority

These are your guarantees:

	<p>We obtain the following qualifications, synonym of guarantee with regard to our traditional know how.</p> <ul style="list-style-type: none"> - Qual 4313 superior skills in wooden joinery - Qual. 4381 supply and setting of wooden joinery - Qual. 4393 restoration of classified buildings
	<p>As a member of the French Quality Charter “Menuiseries 21”, we warrant you a technical and environmental process..</p>
	<p>We have obtained the label “Entreprise du Patrimoine Vivant” (Living Heritage enterprise) for our renowned “savoir-faire” in the practice of traditional and highly technical skills.</p>
	<p>We set up a process, with the Agency for the protection of Environment and control of Energy (ADEME) to use woods coming from forests managed with environment protection purpose</p>
	<p>Glazing we use for our joineries come from qualified suppliers by the CEKAL organism.</p>
	<p>QUALICOAT European label : the quality guarantee for aluminum powder coating.</p>
	<p>We guarantee 10 years:</p> <ul style="list-style-type: none"> - the waterproofness and insulation of our joineries, subject to a normal use (not included : hardware), - durability and uniformity of the thermolaque hardwearing finish (optional : thermolaque guarantee 20 years)
	<p>We guarantee two years hardware components.</p>

Some References

In France

Abbey - Saint Florent le Vieil (49)
American Bank Boulevard Haussmann - Paris
Convent of Jacobins - Britany
Superior School - Paris
Offices of the French Building Federation
Hospital Saint Jacques - Paris
Townhouse of Lassay (National Assembly) - Paris
Finance Building - Paris
Townhouse Cayré - Paris
Townhouse La Marine - Paris
Townhouse Michelet - Paris
Townhouse Odéon - Paris
Townhouse Paris - Nantes
Buildings Haussmann Boulevard - Paris

High School Buffon - Paris
High School Notre Dame Grandchamp - Versailles
High School St Thomas d'Aquin - Ancenis (44)
Department store La Samaritaine - Paris
Administrative Court of Poitiers
Court of Les Sables d'Olonne
Theatre of Angers (49)
University Cap Gémini (60)
Private mansions in Monaco, Saint Jean Cap Ferrat, Courchevel, Versailles, Cap d'Ail

Many private buildings in Paris
And many other apartments, private houses and manors in France.

Abroad

French embassies in the whole world.
Private houses and manors in Boston, Chicago, Los Angeles, New York, Midland (TX) (USA)
Villa in Lisbonne (Portugal), Dublin (Ireland), London (Great Britain).

Contact

California Distributor

THE GOLDEN LION

Office:

2520 Lincoln Blvd.
Venice, CA 90291
(310) 827-6600

Showroom:

225 North Robertson Blvd.
Beverly Hills, CA 90211
(310) 246-1752

www.THEGOLDENLION.com