

# Phyllibert

The 'Phyllibert' collection takes its name from a specific insect. The Phylliidae, 'walking leaf', uses camouflage to appear as a leaf. To further confuse predators, when the insect walks, it rocks back and forth, to mimic a real leaf being blown by the wind.





---

The 'Phyllibert' collection is made of solid brass with a lacquered polished brass finish. Other finishes are available on demand.

---

## Door handle

### Lever handle on rose left or right

BEQU-45001-LD  
ROSA-STUDIO-C45-L

handle  
L: 118 mm  
D : 69 mm  
rose:  
45 x 45 x 5 mm

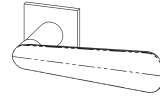

---

## Door accessories

### Thumb turn on rose left or right

BCON-45001-L  
ROSA-STUDIO-C45-L

thumb turn  
L: 32 mm  
D : 28 mm  
rose:  
45 x 45 x 5 mm

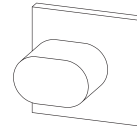

### Lever handle on plate left or right

BEQU-45001-LD (right)  
PLAQ-45001-L (right)  
Plate exists in small (200\*40)

L : 420 mm  
W : 50 mm  
D : 5 mm

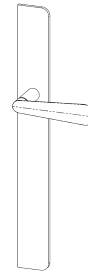

---

## Furniture accessory

### Furniture knob

BMEU-45001-L

L : 46 mm  
D : 24 mm

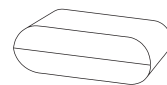



## Jean-Francois D'Or

Exploring numerous materials, Jean-Francois D'Or brings out their beauty without ostentation. His simple, unpretentious, logical objects appeal with their evident, clearly perceptible design as well as their discrete poetry. The designer's approach takes account of company imperatives as well as user needs and is tempered by the desire to reach a market.



**Maison Vervloet**  
Rue de la Borne 78  
1080 Brussels  
Belgium

[info@vervloet.com](mailto:info@vervloet.com)  
[www.vervloet.com](http://www.vervloet.com)